

Product Information

The VDA140CSHR-VFA12IR is a stylish dome camera featuring several unique innovations, allowing unprecedented flexibility by its modular design. The Camera enclosure is dual-format, allowing surface mount with the base attached. Remove the base and you've got a flush mount dome camera! No need to stock 2 different cameras when one will do it all!

Breaking traditions in Camera design, the VDA140 encloses the IR camera module into a round ball, and fits snugly into a magnetic cradle. This allows easy tool-less adjustment of the camera view, with granular positioning in the simplest way possible. And the ball can be quickly replaced if you need a different lens option or for servicing.

The VDA140 makes an exceptional solution for any outdoor application where you need a true, day/night camera with IR illumination.

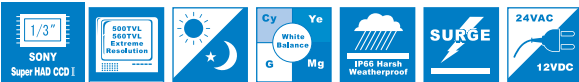

Key Features

- 1/3" Sony Super HAD CCD II
- 3.3-12mm Varifocal Lens
- Stable focus for Day & Night (No IR focus shift)
- True Day/Night Operation (ICR)
- High 500TVL resolution (Day) & 560TVL (Night)
- IR LED's for 66' viewable distance @ 0 lux
- Intelligent IR Protection extends LED lifespan
- Dual Surface/Flush mount
- Weatherproof IP66 rated
- Unique Magnetic gymbal for tool-free adjustment
- 12VDC/24VAC Dual Power, non-polarity

MODEL	VDA140CSHR-VFA12IR
Image sensor	1/3" Sony super HAD CCD II
Effective Pixels	NTSC : 768(H) x 494(V) PAL : 752(H) x 582(V)
H.Resolution	500 TVL (Day) / 560 TVL (Night)
Sync system	Internal
Scanning system	NTSC : 525 Lines PAL : 625 Lines 2:1 Interlaced
Video output	1.0Vp-p Composite. 75 Ohms
S/N ratio	More than 50 dB (AGC Off)
Min. illumination	0.1 Lux at F1.3 w/o LED, 0Lux with LED
Back Light Compensation	Auto
White Balance	Automatic 2,100°K ~ 9,100°K
Gain Control	-6dB~32dB Aut o
Gamma correction	$\gamma = 0.45$
Smear Effect	0.005%
Shutter Speed	NTSC : 1/60~1/100,000 sec. Auto PAL : 1/50 ~ 1/100,000 sec. Auto
IR LED	850nm-Ø8 X 40° X 10ea
IR beam distance	66' (20M)
MTBF	20,000 Hours
Power source	12VDC / 24VAC Dual power
Operating current	400mA at 12VDC, 190mA at 24VAC
Lens	3.3~12mm (F1.3)
Operating Temperature	14°F ~ 122°F (-10°C ~ +5 0°C)
Humidity	Within 90% RH
Measurement (mm)	150(Ø) X 115.7(H)
Weight (Approx.g)	2,000

Dimension

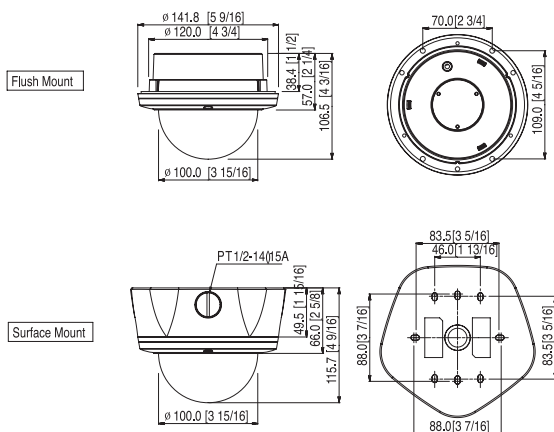

Function

