



- Video matrix, configuration through OSD (On Screen Display)
- 8 video inputs, expandable to 16
- 4 video outputs
- Remote control by max 4 operators
- Telemetry line
- Controllable by PC
- Privacy video-masking function

The SM84B -SM164B matrix is a microprocessor remote-controlled video matrix which allows the video switching of 8-16 cameras on 4 outputs.

A OSD programmable password ensures protection from improper use of the matrix.

The switching is controlled by a maximum of 4 remote keyboards in RS485.

The keyboards, remote up to maximum distance of 1200m (3937ft), allows the video switching and matrix set-up, on screen and telemetry control through the same matrix.

8-16 alarm contacts can be associated with the corresponding video inputs. In case of alarm, the alarmed video input can be displayed on the video outputs. The alarm contacts are independent and configured as Normally Open (NO) or Normally Closed (NC). The reset of an alarm situation is performed through keyboard, external contact or time-out.

The telemetry control can be performed on coax cable on the 8-16 video inputs and on the RS485 serial output.

Furthermore, it is possible to control the video switching by a VCR trigger signal.

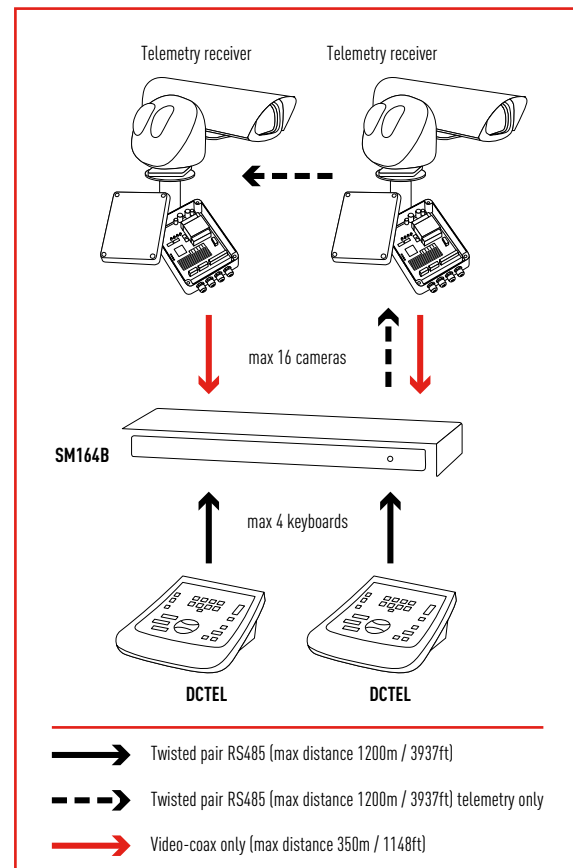

13 VIDEO SWITCHING

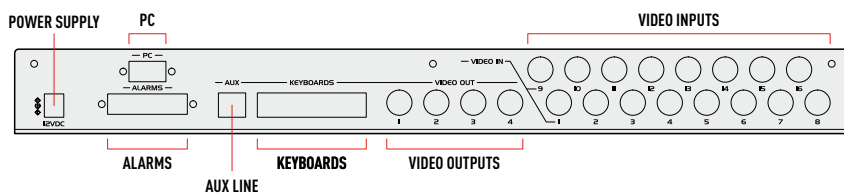



### TECHNICAL DATA

#### GENERAL

Max 8-16 cameras  
 Max 4 monitors  
 Max 4 remote keyboards  
 On screen display video programming  
 Menu in four languages (Italian, English, French and German)  
 Different switching sequences for each video output  
 Identification texts for each output  
 Date and time management  
 Types of alarm reset: manual from keyboard, external, timed automatically  
 Completely configurable alarm inputs for all 8-16 video inputs  
 VCR trigger management  
 Alarm condition warning buzzer  
 Relay can be activated by each alarm  
 Telemetry control on RS485 auxiliary line and on coaxial cable  
 Video signal masking on fixed camera for privacy purposes  
 Input 75 Ohm load disconnectable  
 Supplied with instruction manual, wide range power supply, 3 power cables, 2 RJ11 telephone cables, 2 jack shunt boxes RJ11, 1 DB25 connector

#### MECHANICAL

Steel box  
 Epoxypolyester powder painting, RAL7036 colour  
 Dimensions: Rack 19", 1U, dim. 436.6x163x445mm (17.2x6.4x17.5in)  
 1XDB25 connector (alarm)  
 5 connectors RJ11 (4 for keyboards and 1 for telemetry line)  
 1xpower supply jack connector  
 1xDB9 female connector (PC)  
 8-16 BNC video inputs  
 4 BNC video outputs

#### ELECTRICAL

Power supply: IN 100-240Vac - OUT 12Vdc, 47/63Hz, 1A  
 Power consumption: 15W max  
 8-16 inputs 75 Ohm 1Vpp (PAL/NTSC)  
 4 outputs 75 Ohm 1Vpp (PAL/NTSC);  
 Bandwidth: > 6MHz  
 Lower cut-off frequency [-3dB]: 9Hz  
 Signal/noise ratio: >48dB@5.5MHz  
 Relay contact: 50Vac, 0.3A

#### COMMUNICATIONS

Telemetry transmission on coax cable on the 8-16 video inputs (min distance 5m (16.4ft) and max 350m (1148ft)  
 Telemetry data transmission on serial output RS485 for a max distance of 1200m (3937ft)  
 Four serial inputs RS485 for the reception of data from max 4 remote keyboards from a max distance of 1200m (3937ft)  
 Serial input RS232 for firmware update and PC control from a max distance of 15m (49ft)

#### PROTOCOLS

##### Telemetry Line

VIDEOTEC (1200, 9600 baudrate)  
 MACRO (1200, 9600, 19200, 38400 baudrate)  
 PELCO D (2400, 4800, 9600, 19200 baudrate)

*PELCO is registered trademark.*

*Because SM84B-SM164B may be interfaced with equipment not manufactured by VIDEOTEC, it is possible that the interface protocols have changed or are in a different configuration from earlier tested units from us. Because VIDEOTEC recommends a bench test prior to installation, VIDEOTEC will not be liable for any installation costs or lost revenues in the event a compatibility problem will occur.*

#### ACCESSORIES

**SMEX8** Expansion 8 inputs board for SM84B

#### RELATED PRODUCTS

**DCBD** Keyboard for matrix control  
**DCTEL** Keyboard for matrix and telemetry control  
**DCIR** Infrared Remote Control  
**DCK** Keyboard to control matrix and multiplexers  
**DCJ** Keyboard to control matrix, multiplexers and telemetry equipped with three axis joystick  
**DCT** Touch screen keyboard to control matrix, multiplexers, DVRs and telemetry equipped with three axis joystick  
**MICRODEC485** Mini telemetry receiver 8 functions, 24Vac  
**DTMRX224** Telemetry receiver 12 functions, 24Vac  
**DTMRX2** Telemetry receiver 12 functions, 230Vac  
**DTRX324** Telemetry receiver 17 functions, 24Vac  
**DTRX3** Telemetry receiver 17 functions, 230Vac  
**DTCOAX** Over the coax board for DTRX3 only trough matrix series SM  
**DTRXDC** Telemetry receiver 13 functions, for PTH355P  
**ULISSE** Positioning Unit

*Retrofit on discontinued products; contact VIDEOTEC for further specifications.*

#### ENVIRONMENT

Indoor  
 Operating temperature: 0°C / +40°C (+32°F / +104°F)

#### COMPLIANCE TO

CE according to EN 61000-6-3, EN 60950-1, EN 55022 Class B, EN 50130-4  
 FCC according to Part. 15 Class B



**Unit Weight:**  
**SM84-164B** 3.4kg / 7.5lb

**Package Weight:**  
**SM84-164B** 3.7kg / 8.1lb

**Package Dimensions (WxHxL):**  
**SM84-164B** 51.5x18.5x11.5cm / 20.2x7.3x4.5in

**Master Carton:**  
**SM84-164B** -