

C•CURE Go Install

Mobile App for System Status
and Network Configuration of
iSTAR Ultra LT Door Controller



Features That Make a Difference:

- Quickly configure network settings and monitor live output of iSTAR Ultra LT
- Easily view recorded data and boot-up log information for quick audit trail
- Quickly reboot iSTAR Ultra LT should the unit go offline
- Available for free on the iTunes App Store and Google Play

Real-Time Data Feed Replaces LCD

C•CURE Go Install mobile app provides real-time system data via a smartphone using Bluetooth technology to quickly configure network settings, easily view device status, and reboot iSTAR Ultra LT door controllers. The mobile app replaces a traditional LCD that provides pertinent iSTAR Ultra LT system data for installers and users of the system.

Quick and Easy Network Set-Up of iSTAR Ultra LT Controllers

C•CURE Go Install allows you to quickly and easily communicate directly with iSTAR Ultra LT door controllers, configure the network settings and quickly gather diagnostics of the device. You can select from a list of existing iSTAR Ultra LT controllers and quickly configure each controller in a few simple steps. Simply click on the app and enter login credentials to gain access. The app will connect to the network through Bluetooth and detect all iSTAR Ultra LT door controllers in the local vicinity. Once you select the appropriate iSTAR Ultra LT, you are given several options: Configuration, Live Output, Device Status, Reboot and Bootup Log. The Configuration option allows you to add or change the IP address and a host IP address, and a variety of other system parameters. Device Status provides you with system information such as controller name, firmware version, CPU usage, RAM available, and more. All system information is at your fingertips.

Rebooting Made Easy

If an iSTAR Ultra LT goes offline, C•CURE Go Install allows you to reboot the controller without having to climb a ladder to hit the reset button. This is especially important for facilities, such as hospitals, that are required to adhere to strict safety protocols. For example, in a hospital when a ladder is used, an enclosure is required to be placed around the ladder to prevent injuries from occurring. With the mobile app, all rebooting can be done from one convenient mobile device. No ladder necessary.

Convenient Bootup Log

For quick diagnostics of the controller, a convenient bootup log is available to show everything that transpired since bringing the device online.

Highly Secure

Once you set up an iSTAR Ultra LT with network parameters using the mobile app, the controller connects to the C•CURE 9000 server, all configuration data is downloaded from the server, and the iSTAR Ultra LT controller is managed centrally from C•CURE 9000. For added security, C•CURE 9000 will then shut down the Bluetooth so the system cannot be accessed by unauthorized users. A controller's Bluetooth functionality can then be centrally controlled through C•CURE 9000, on a per-controller basis. An operator can turn on the BLE service temporarily while local service work is being done. In addition, a password is required before C•CURE Go Install can connect to a controller.

Lower Install Costs, Call Backs and Integration Setup Time with C•CURE Go Install Mobile App

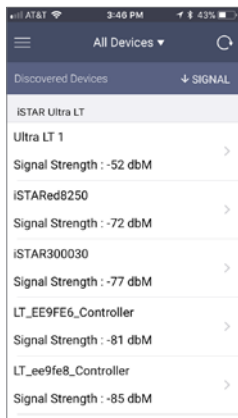

All Devices in Local Vicinity

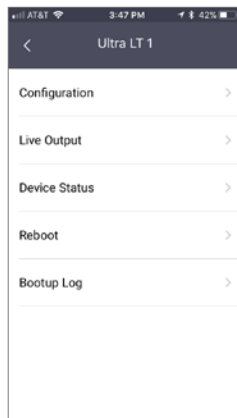

System Options



Configuration



Live Output

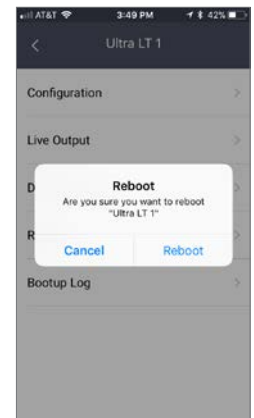

Reboot Option



Device Status

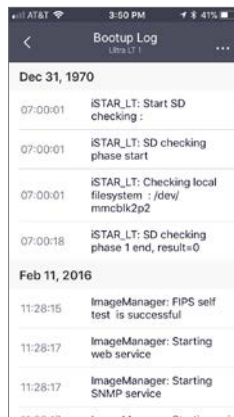

Bootup Log

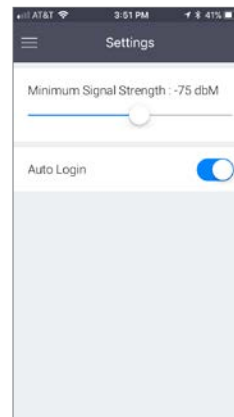

System Settings

Specifications

C•CURE 9000 Compatibility C•CURE 9000 v2.60 SP1 or higher
 Controller Compatibility iSTAR Ultra LT firmware v6.5.4 or higher
 Connectivity Bluetooth
 Supported Mobile Platform iOS and Android smartphones and tablets
 Default Threshold BLE Range 75db for BLE discovery; can be adjusted

Ordering Information

The free C•CURE Go Install mobile app can be found on the iTunes App Store and Google Play Store

Requirements

- Installed Bluetooth antenna on the iSTAR Ultra LT board
- Enable Bluetooth connectivity feature in C•CURE 9000
- Bluetooth enabled on iOS or Android device and sufficient space for downloading and operating
- Close physical proximity for full functionality

Related Products



iSTAR Ultra LT



C•CURE 9000