



# 12FA Series Fixed Focal Lens

## 1/2-INCH FORMAT, MANUAL IRIS

### Product Features

- C Mount
- For use with 1/2-Inch Format Cameras
- Manual Iris, Manual Focus
- Can Be Adapted for Use on CS-Mount Cameras with Optional C-to-CS Mount Adapter
- High Resolution Power in Compact Body



12FA6C

Pelco's **12FA Series** offers a compact, economical, high-quality selection of manual iris, fixed focal length lenses. All **12FA Series** lenses have a C mount. The optional PCMA40 CS-mount adapter can be used to fit the C-mount lenses to CS-mount cameras. Pelco's 1/2- and 1/3-inch CCTV cameras having an electronic iris function are a perfect match for these lenses.

The lenses range from a 3.5 mm lens with an extra-wide field of view to a 12 mm lens with a normal view (when used on a 1/2-inch camera). They utilize a manual iris that adjusts from f1.4 to fully closed with an iris opening of f1.4. The lenses are ideal for low-light conditions.

Select the model lens that best suits your needs from the Technical Specifications section of this product specification sheet.

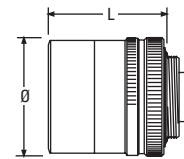

	Ø		L	
12FA3.5C	1.40	(3.56)	1.22	(3.10)
12FA4.5C	1.40	(3.56)	1.26	(3.20)
12FA6C	1.40	(3.56)	1.37	(3.48)
12FA12C	1.40	(3.56)	1.19	(3.02)

NOTE: VALUES IN PARENTHESES ARE CENTIMETERS; ALL OTHERS ARE INCHES.



DataFAX  
SPEC: 2782  
MANUAL: 27476

C782 / REVISED 10-02

International Organization  
for Standardization;  
Registered ISO 9001



# TECHNICAL SPECIFICATIONS

## MODELS

	<b>12FA3.5C</b>	<b>12FA4.5C</b>	<b>12FA6C</b>	<b>12FA12C</b>
Type	Fixed Focal Length	Fixed Focal Length	Fixed Focal Length	Fixed Focal Length
Format Size	1/2-inch	1/2-inch	1/2-inch	1/2-inch
Mount Type	C	C	C	C
Focal Length	3.5 mm	4.5 mm	6 mm	12 mm
Relative Aperture (F)	1.4~Close	1.4~Close	1.4~Close	1.4~Close
Operation				
Iris	Manual	Manual	Manual	Manual
Focus	Manual	Manual	Manual	Manual
Zoom	—	—	—	—
Angle of View				
Diagonal	132.1°	98.2°	69.4°	37.5°
Horizontal	103.6°	79.0°	57.3°	30.3°
Vertical	76.6°	59.4°	44.0°	22.6°
Minimum Object Distance	0.2 m	0.2 m	0.2 m	0.3 m
Back Focal Length	8.55 mm	7.56 mm	8.06 mm	8.06 mm
Filter Size (mm)	30.5P0.5	30.5P0.5	30.5P0.5	30.5P0.5
Unit Weight	0.13 (0.06 kg)	0.13 (0.06 kg)	0.13 (0.06 kg)	0.13 (0.06 kg)
Shipping Weight	1 lb (0.45 kg)	1 lb (0.45 kg)	1 lb (0.45 kg)	1 lb (0.45 kg)

## OPTIONAL ACCESSORIES

PCMA40	Universal 5 mm ring adapter; adapts C-mount lens to CS-mount camera
--------	---



**Pelco Worldwide Headquarters:**  
3500 Pelco Way, Clovis, California 93612-5699 USA  
**USA & Canada** Tel: (800) 289-9100 • FAX (800) 289-9150 • DataFAX (800) 289-9108  
**International** Tel: (559) 292-1981 • FAX (559) 348-1120 • DataFAX (559) 292-0435  
[www.pelco.com](http://www.pelco.com)

Specifications subject to change without notice.  
©Copyright 2002, Pelco. All rights reserved.