

2 Cab Elevator Floor Access Control Panel

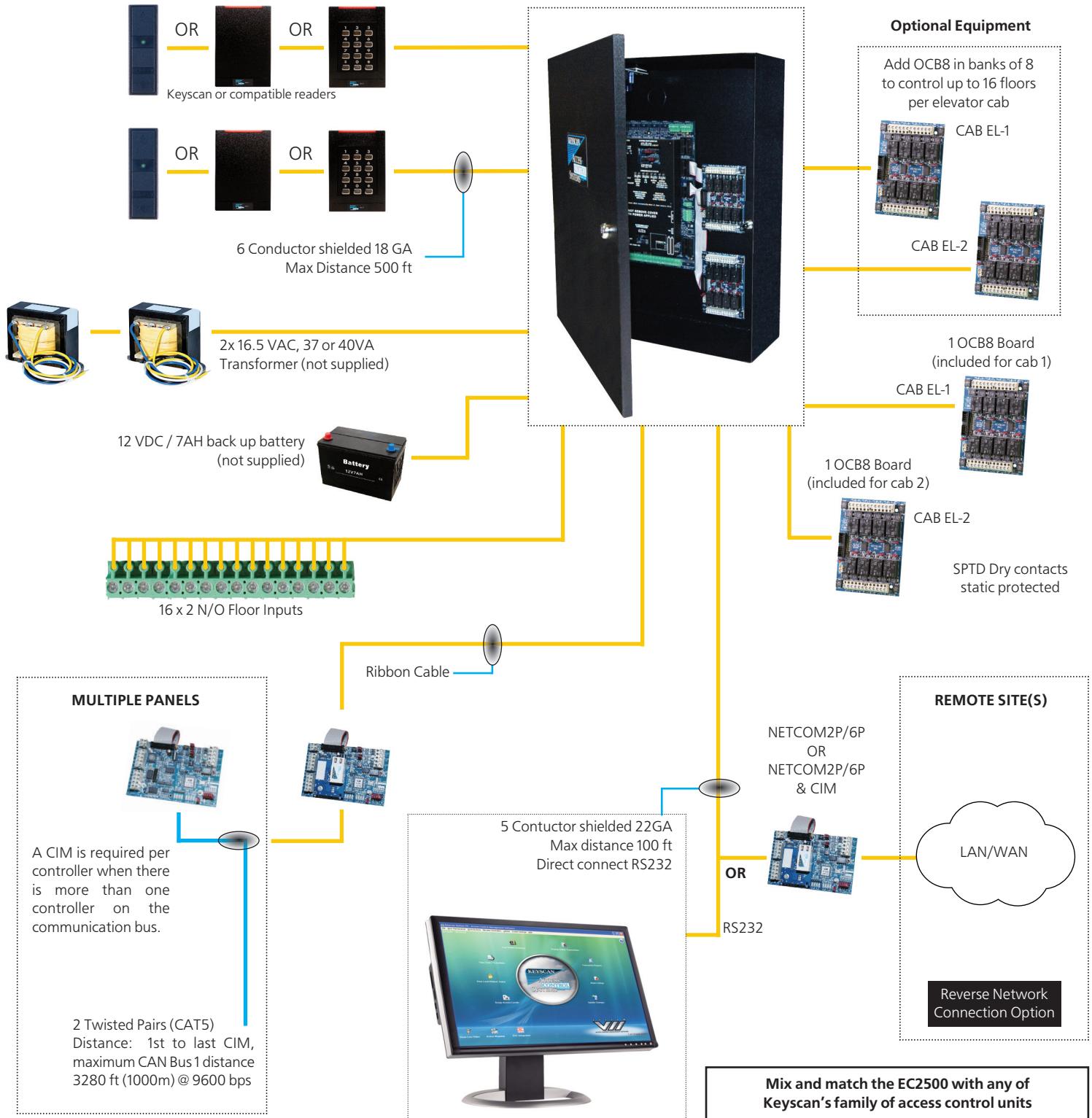

EC2500

2 Cab Elevator Floor Access Control Panel

		PoE Single Door Control System	Multiple Reader Access Control Systems				Elevator Floor Control Systems	
								
		CA150	CA250	CA4500	CA8500	EC1500	EC2500	
Access Control Unit	Doors/Elevator Floors Supported	1 door	2 doors	4 doors	8 doors	1 cab (up to 40 floors)	2 cabs (up to 16 floors)	
	Reader Ports	2 (In/Out)	2	4	8	1	2	
	Multi-ACU Compatibility	Yes (Ethernet)	Yes	Yes	Yes	Yes	Yes	
	System Status LEDs	Yes	Yes	Yes	Yes	Yes	Yes	
	Dual Processors	Yes	Yes	Yes	Yes	Yes	Yes	
	Flash Memory	Yes	Yes	Yes	Yes	Yes	Yes	
	Power Fail Output	NA	Yes	Yes	Yes	Yes	Yes	
Floor Monitor Inputs (Supervised)	NA	NA	NA	NA	NA	Yes	Yes	
Inputs	Request to Exit (RTE) Inputs (Supervised)	1	2	4	8	NA	NA	
	Door Contact Inputs	1	2	4	8	NA	NA	
	Auxiliary Inputs (Supervised)	2	8	16	16	NA	NA	
	I/O Input Expansion	NA	NA	64 (banks of 16)	64 (banks of 16)	NA	NA	
Outputs	Auxiliary Output Relays	1	2	4	8	NA	NA	
	Expansion Auxiliary Output Relays	NA	NA	8	8	NA	NA	
	I/O Outputs	NA	NA	64 (banks of 16)	64 (banks of 16)	NA	NA	
	Door Output Relays	1	2	4	8	NA	NA	
Capacity	No. of Cardholders	32,000	32,000	32,000	32,000	32,000	32,000	
	Transaction File Buffer	6000	6000	6000	6000	6000	6000	
	Time Zones	256	256	256	256	256	256	
	Time Schedules	512	512	512	512	512	512	
	Group Levels	511	511	511	511	511	511	
Holiday Dates	64	64	64	64	64	64		
Connectivity	Ethernet Ready	Equipped	Optional	Optional	Optional	Optional	Optional	
	PoE - Power over Ethernet (IEEE 802.3af)	Equipped	NA	NA	NA	NA	NA	
	CMAC Reverse IP	Equipped	Optional	Optional	Optional	Optional	Optional	
	Serial Communication	Yes (single panel)	Yes	Yes	Yes	Yes	Yes	