

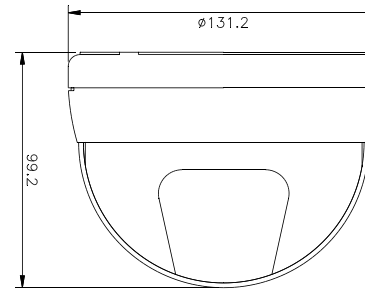

# HTC-15 SERIES DOME CAMERA

## FEATURES

- Versatile assembly
- DSP colour camera
- AC24V with Line Lock available
- SONY Ex-view sensor available
- Night vision available for colour camera
- Auto switching to monochrome under low light condition (option)



**Special Price for Over 10Pcs (Inclusive),  
Please Contact:020 8965 0111 or E-mail:sales@huntelelect.co.uk**  
B/W DOME

	MONOCHROME	COLOUR
Pick-up Device	1/3" CCD image sensor	
Picture Elements	Sony ip: NTSC/EIA: 510*492 / 768*494 (hi-res.), PAL/CCIR: 500*582 / 752*582 (hi-res.)	
	Panasonic chip: NTSC/EIA: 512*492 / 771*492 (hi-res.), PAL/CCIR: 512*582 / 753*582 (hi-res.)	
H. Sync Frequency	NTSC :15.734 KHz, PAL : 15.625 KHz	
V. Sync. Frequency	NTSC : 59.94 Hz, PAL : 50 Hz	
Synchronization	DC : Internal, AC : Line Lock (option)	
Horizontal Resolution (TV lines)	420 / 580 (Hi-res.)	380 / 480 (Hi-res.)
Back Light Compensation	AUTO	
Electronic Shutter	AUTO, Range: 1/50 (1/60) up to 1/100,000 sec.	
Gamma Correction	0.45	
Gain Control	AUTO	
Lens	CS mount, varifocal auto iris 4-8mm lens, 3.6mm lens (2.9, 6, 8, 12mm)	
S/N Ratio	More than 48dB (AGC OFF)	
Video Output	1 Vp-p, 75 Ohms	
Dimension mm	φ 131.2* H99.2	
Power Supply	12VDC or 24VAC	
Power Consumption	115/135mA (hi-res.) at DC power	200/220mA (hi-res.) at DC power
Weight gr	DC: 360, AC: 380	
Storage Temperature	-30°C ~ +60°C	
Operating Temperature	-10°C ~ +45°C	

SPECIFICATIONS ARE SUBJECT TO CHANGE WITHOUT NOTICE

Model	B/W	Color	DC	AC24V	Med-res.	Hi-res.	Lens	Chips	Sensitivity
HTC-153/3.6	○		○	○	○		3.6mm	Sony	0.1
HTC-153/4-8	○		○	○	○		4-8mm	Sony	0.1
HTC-153/CS	○		○	○	○		CS	Sony	0.1
HTC-156/3.6	○		○	○		○	3.6mm	Sony	0.2
HTC-156/4-8	○		○	○		○	4-8mm	Sony	0.2
HTC-156/CS	○		○	○		○	CS	Sony	0.2
HTC-15C/3.6		○	○	○	○			Sony	1
HTC-15C/4-8		○	○	○	○		4-8mm	Sony	1
HTC-15C/CS		○	○	○	○		CS	Sony	1
HTC-15G/3.6		○	○	○		○	3.6mm	Sony	2
HTC-15G/4-8		○	○	○		○	4-8mm	Sony	2
HTC-15G/CS		○	○	○		○	CS	Sony	2

MODEL	DESCRIPTION
HTC-153/3.6	1/3" med-res. B/W dome, 3.6mm lens, 420 TV Lines, 0.1 Lux, DC12V, Sony chips
HTC-153/CS	1/3" med-res. B/W dome, CS mount, 420 TV Lines, 0.1 Lux, DC12V, Sony chips
HTC-153/4-8	1/3" med-res. B/W dome, 4-8mm varifocal lens, 420 TV Lines, 0.1 Lux, DC12V, Sony chips
HTC-156/3.6	1/3" hi-res. B/W dome, 3.6mm lens, 520 TV Lines, 0.2 Lux, DC12V, Sony chips
HTC-156/CS	1/3" hi-res. B/W dome, CS mount, 520 TV Lines, 0.2 Lux, DC12V, Sony chips
HTC-156/4-8	1/3" hi-res. B/W dome, 4-8mm varifocal lens, 520 TV Lines, 0.2Lux, DC12V, Sony chips

## COLOUR VANDAL DOME

MODEL	DESCRIPTION
HTC-15C/3.6	1/3" med-res. colour dome, 3.6mm lens, 380 TV Lines, 1 Lux, DC12V, Sony chips
HTC-15C/CS	1/3" med-res. colour dome, CS mount, 380 TV Lines, 1 Lux, DC12V, Sony chips
HTC-15C/4-8	1/3" med-res. colour dome, 4-8mm varifocal lens, 420 TV Lines, 1 Lux, DC12V, Sony chips
HTC-15G/3.6	1/3" hi-res. colour dome, 3.6mm lens, 480 TV Lines, 2 Lux, DC12V, Sony chips
HTC-15G/CS	1/3" hi-res. colour dome, CS mount, 480 TV Lines, 2 Lux, DC12V, Sony chips
HTC-15G/4-8	1/3" hi-res. colour dome, 4-8mm varifocal lens, 480 TV Lines, 2 Lux, DC12V, Sony chips