

1/3" Standard Resolution Full-Featured Color Camera

ADEMCO Video's ACC334TP 1/3-inch CCD standard resolution color camera is the premier choice for any surveillance application. Part of ADEMCO Video's Systems Series high-end cameras, the sophisticated ACC334TP is one of the first to incorporate Sony's *new* CCD chip technology, which delivers superior sensitivity, greater dynamic range, and reduced smear to satisfy even the most stringent viewing requirements. The ACC334TP features a standard resolution of 330 TV lines and Digital Signal Processing (DSP) for clean, sharp images.

Adaptable to varying light levels, the ACC334TP features a high sensitivity of 0.5 lux @ F1.2 and four user-selectable BLC windows providing the flexibility to view high contrast scenes from almost any angle.

The ACC334TP is digital-ready. Ideal for use with today's digital video recorders including ADEMCO Video's Rapid Eye Multi, and AVDR Series Digital Video Recorders, the ACC334TP features a Discrete Cosine Transformation (DCT) switch which significantly reduces noise in low light scenes, thereby increasing the number of recording days by as much as 50%. This eliminates the need to purchase additional storage capacity.

The ACC334TP camera can be installed using conventional coax, or, unshielded twisted pair (UTP) with its built-in NVT transceiver. UTP provides the ultimate in flexibility, and offers a significant advantage in labor and material savings. The ACC334TP mounts quickly and easily using the camera's built-in 1/4" UNC-20 top or bottom-mounting receptacles. Installers can backfocus the camera using its convenient thumbwheel—no tools are necessary. The camera features a switching power supply that enables multiple cameras to be connected to a 24VAC or 12VDC source.

The ACC334TP is part of ADEMCO Video's Systems Series – products that deliver increased flexibility, superior performance, and advanced technologies for today's most demanding applications.

FEATURES:

- 1/3" interline transfer CCD
- Coax or Unshielded Twisted Pair video transmission
- Discrete Cosine Transformation (DCT) Switch
- Backlight compensation (4 windows)
- 330 lines horizontal resolution
- High sensitivity- 0.5 lux @ F1.2
- Adjustable Peak/Avg. for DD lenses
- SPS 12VDC/24VAC
- Tool-less back focus
- AGC (on/off)
- CS or C mount
- Supports DD or video drive auto iris lenses
- Built in mounting receptacle (top or bottom)
- Power LED (on/off)

Systems
Series



ACC334TP
(NTSC)

ACC334TPX
(PAL)

**ADEMCO
VIDEO**

ACC334TP(X)

Powerful new features offer exceptional performance for both standard and complex lighting conditions:

Cost Savings and Flexibility

The new ACC334TP is designed for two methods of video transmission—Coax and Unshielded Twisted Pair (UTP).* Built-in Unshielded Twisted Pair transceivers provide a significant advantage in labor/material savings on installations.

With UTP...

- Wire runs can be made more quickly and easily
- Easily connects to Category 5 cable that may already exist in a facility, reducing long wire runs through ceilings or walls
- Four cameras can be installed with one wire run of Category 5 (two pair of four)
- Power and video on the same bundle with wire runs up to 300 feet
- Offers interference immunity to cables on the same bundle, fluorescent lights, transformers, motors and RF transmitters
- Wire runs over a mile with an active receiver/transmitter

*ADEMCO Video only guarantees optimal video w/NVT manufactured products.

Discrete Cosine Transformation (DCT)

The ACC334TP is ideal for use with Digital Video Recorders. Unlike conventional CCD cameras, the ACC334TP features a Discrete Cosine Transformation (DCT) switch, that, when activated, reduces noise in low light levels. Reducing noise in a scene can increase the amount of recording days by over 50% without having to expand the memory in a system.

See "controls and switches" diagram on facing page

Back Light Compensation (BLC)

Provides four different variations of BLC windows for extended application use. Its ability to handle most high contrast scenes allows for a seamless install with optimal picture quality.



Before



After

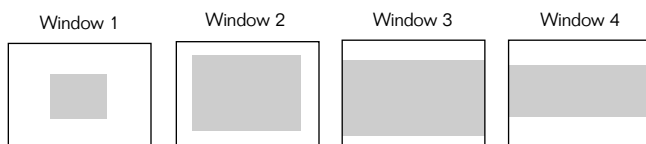

■ Indicates area used to calculate the exposure

Built in female mounting receptacle

The ACC334TP can be mounted quickly and easily with the built-in 1/4" UNC-20 receptacle. The camera can be mounted from the top or bottom without having to remove a sled.

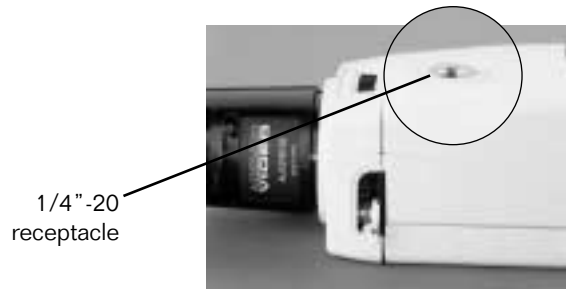

Back Focus Adjustments

Back focusing is seamless. By turning the convenient built-in thumbwheel, the installer can adjust the camera for optimal focus, quickly and easily. This adjustment requires no tools.

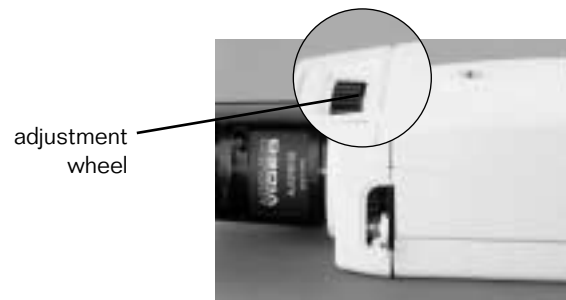

Sharpness/Aperture On/Off Switch

This feature increases the sharpness of the scene, by increasing the aperture correction, which emphasizes the edges of the objects in the scene.

See "controls and switches" diagram on facing page.

Features/Controls

Easily accessible controls make set-up and adjustments quick and easy.

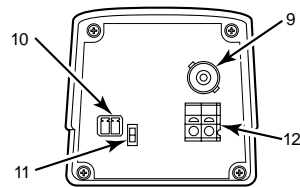
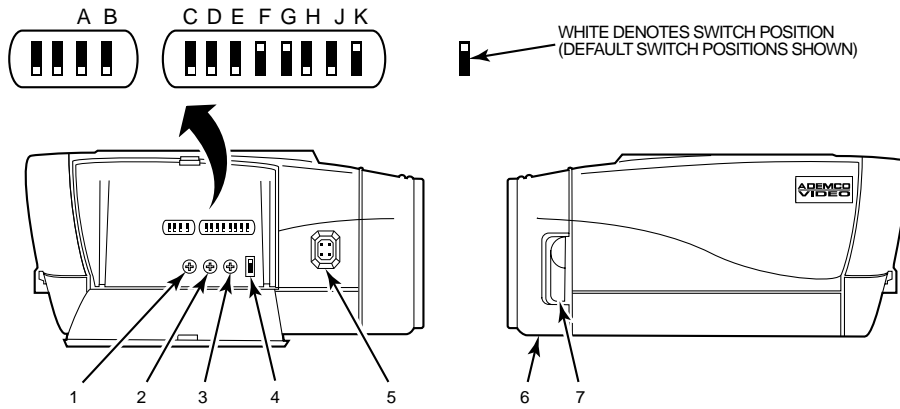

CONTROLS AND SWITCHES

- | | |
|--|---|
| A. BACKLIGHT COMPENSATION WINDOW SWITCH | 1. LINE-LOCK PHASE ADJUSTMENT |
| B. BACKLIGHT COMPENSATION WINDOW SWITCH | 2. DD LENS LEVEL ADJUSTMENT |
| C. DISCRETE COSINE TRANSFORMATION ON/OFF | 3. DD PEAK-AVERAGE ADJUSTMENT |
| D. SHARPNESS ON/OFF | 4. AUTO-IRIS LENS SELECTOR SWITCH |
| E. GAMMA SECTION | 5. AUTO-IRIS CONNECTOR |
| F. AGC ON/OFF | 6. BACK FOCUS ADJUSTMENT |
| G. ELECTRONIC IRIS ON/OFF | 7. BACK FOCUS ADJUSTMENT LOCK |
| H. BACKLIGHT COMPENSATION ON/OFF | 9. COMPOSITE VIDEO OUTPUT |
| J. SYNCHRONIZATION SELECT | 10. TWISTED-PAIR VIDEO OUTPUT TERMINALS |
| K. POWER LED ON/OFF | 11. VIDEO OUTPUT TYPE SELECTOR SWITCH |
| | 12. LOW-VOLTAGE SUPPLY TERMINALS |

Dimensions

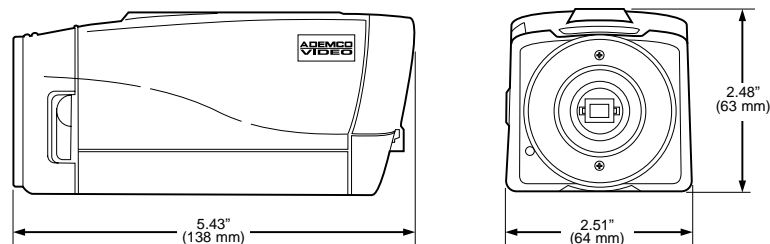

ACC334TP(X)

SPECIFICATIONS:

OPERATIONAL

- **Image Sensor:** 1/3" Sony CCD (features new CCD chipset)
- **Effective Pixels:** 510 (H) 492(V) NTSC
500 (H) x 582 (V) PAL
- **Sensitivity:** 0.5 lux, 50 IRE with F1.2 lens and 80% scene reflectance
- **Resolution:** 330 TVL
- **Signal to Noise Ratio:** 48dB (AGC Off)
- **Peak White Iversion:** Adjustable
- **Discrete Cosine Transformation Switch (DCT):** On/Off selectable
- **Sharpness Aperture:** On/Off selectable
- **AGC:** On/Off selectable
- **Auto Electronic Iris:**
NTSC 1/60 - 1/100,000 second
PAL 1/50- 1/100,000 second
- **Backlight Compensation:** 4 user selectable windows
- **Sync System:** Internal/Line Lock selectable
- **Adjustable V-Phase:** Adjustable line-lock vertical phase $0 \pm 120^\circ$
- **Level Adjustment:** DD lens level adjustment, peak or average
- **Gamma:** 0.45/0.8 switchable
- **Power LED:** On/Off selectable

LENS OPTIONS

- **Manual:** C or CS mount, (1/3" or larger)
- **Video Iris/Auto Iris:** 4-pin square type socket on the side of the camera can be wired for video lenses
- **DD Iris:** 4-pin square type socket can be connected to side port

ELECTRICAL

- **Power Supply Switching:** 24VAC (20-29) 12VDC (11-28)
- **Internal Power Isolation:** Internal Power Transformer
- **Power Consumption:** <5 watts

MECHANICAL

- **Lens Mount:** C or CS
- **Camera Mount:** 1/4" -20 female thread built into camera body (top & bottom)
- **Dimensions:**
2.51" (W) x 2.48" (H) x 5.43" (D)
64mm x 63mm x 138mm
- **Weight:** 0.66 lbs (.3kg)
- **Color:** Cool Gray

ENVIRONMENTAL

- **Operating Temperature:** 14° to 140° F (-10° to 60° C)
- **Operating Humidity:** 20% to 80% relative humidity, non condensing
- **Storage Temperature:** 14° to 158° F (-10° to 70° C)

VIDEO OUTPUT

- 1 V_{p-p}, 75 ohms
- Unshielded Twisted Pair (UTP)

REGULATORY

- **Safety:** UL: UL2044, CE: EN60950
- **FCC:** Part 15
- **Emissions:** EN: 55022: Class B
- **EMC Immunity:** EN50130-4

**1/3" Standard
Resolution
Full-Featured
Color Camera**

ADEMCO VIDEO

Customer Service . . .800-352-9169
Applications877-653-0302
Technical Support . . .888-238-7978
Fax516-921-4307
www.ademcovideo.com

171 Eileen Way, Syosset, NY 11791

Copyright ©2002 Honeywell

ORDERING:

Part No.	Description
ACC334TP	1/3" Standard Resolution Full-Featured DSP Color Camera 12VDC/24VAC, NTSC
ACC334TPX	1/3" Standard Resolution Full-Featured DSP Color Camera 12VDC/24VAC, PAL

**ADEMCO
VIDEO**