

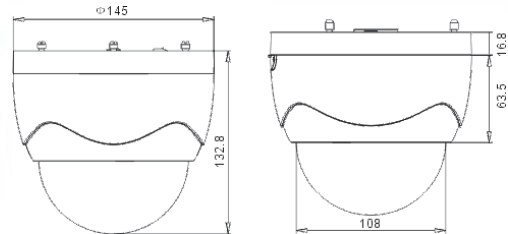

DS-2CD792PF(NF)(-E) IP Camera



Key Features

- High performance Sony CCD
- Linux OS embedded
- TI DaVinci hardware compression
- H.264 dual stream real time video compression in 4CIF/DCIF/2CIF/CIF/QCIF
- SD card local storage
- Support IE client for network preview
- Motion detection with PC client notification

Specifications

Camera

Image Sensor	1/3" Sony Super HAD CCD
Effective Pixels	PAL:752(H)×582(V) NTSC:768(H)×494(V)
Lens	3.5 ~ 9mm@F1.2/Φ14/ Manual Iris Lens
Signal System	PAL/NTSC
Electronic Shutter Speed	1/50(1/60)s to 1/100,000s
Min. Illumination	0.1Lux @ F1.2
Day & Night	Electronic Shutter
S/N Ratio	48dB
Video Output	540TVL,1Vp-p Composite Output (75Ω/BNC)

Functions

Motion Detection	On/Off
Dual Stream	Yes. Contains data for compressed video and audio
SD Card Local Storage	Yes
Heartbeat	Protocol configures network operation
Access Levels	16 simultaneous users w/ remote user privileges
Protocol Support	TCP/IP,HTTP,DHCP,DNS,RTP/RTCP, PPPoE
Adjustment Range	355° Pan 90° Tilt

Compression Standard

Video Compression	H.264 (32 K ~ 8M)
Audio Compression	OggVorbis

Image

Max. Image Resolution	Up to 704x576 Pixels
Frame Rate	Up to 30fps

Interface

Audio Input	1 Channel (2.0 to 2.4Vp-p, 1kΩ)
Audio Output	1 Channel (Line Level, 600Ω)
Communication Interface	1 RJ45 10M/100M Ethernet Port and 1 RS-485 Interface Port
Alarm I/O	1 Channel Input and 1 Channel Reply Output

General

Operating Temperature	-10°C ~ 60°C
Power Supply	12VDC, (-E) Series Support PoE (Power over Ethernet) 4W Max.
Dimensions	φ145mm x 132.8mm
Weight	900 g