

# DS-2CC11A5P(N)-VFIR

## 700 TVL Low Illumination Vari-focal Bullet Camera

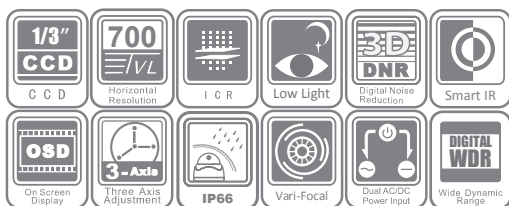

### Key features

- 1/3" SONY CCD
- 700TVL Horizontal Resolution
- 2.8-12mm Vari-focal Lens
- True Day/Night
- OSD Menu, DNR, Smart IR, Eclipse
- 30m IR Distance
- IP66 Rating

### Dimensions

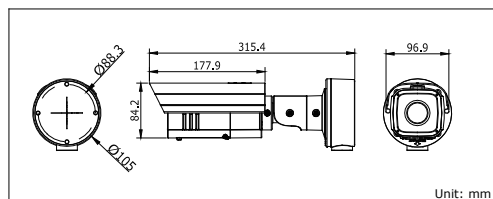

Unit: mm

DS-2CC11A5P(N)-VFIR	
Camera	
Image Sensor	1/3" SONY EXview HAD CCD II
Signal System	PAL/NTSC
Effective Pixels	PAL: 976 (H) × 582 (V) NTSC: 976 (H) × 494 (V)
Min. Illumination	0.001 Lux @ (F1.2, AGC ON), 0.0001 Lux @ (F1.2, AGC ON, sensitivity × 512), 0 Lux with IR 0.0014 Lux @ (F1.4, AGC ON), 0.00014 Lux @ (F1.4, AGC ON, sensitivity × 512), 0 Lux with IR
Shutter speed	PAL: 1/50 s to 1/100,000 s NTSC: 1/60 s to 1/100,000 s
Lens	2.8 - 12 mm @ F1.4 Angle of view: 80° - 27.2°
Lens Mount	φ14
Auto Iris	DC drive
Angle Adjustment	Pan: 0 - 360°, Tilt: 0 - 90°, Rotation: 0 - 360°
Day & Night	IR cut filter with auto switch
Horizontal Resolution	700 TVL
Synchronization	Internal/Power synchronization
Video Output	1Vp-p composite output (75 Ω/BNC); Test monitor out [1Vp-p composite output (75 Ω/BNC), device line]
S/N Ratio	More than 62 dB
Menu	
Camera ID	On/Off (16 letters, position adjustable)
Auto Gain	Low/Middle/High/Off
D/N Mode	Auto/Day/Night
White Balance	Auto trace WB1/Auto trace WB2/Manual/Auto Control
Privacy Mask	On/Off, maximum 12 zones
Motion Detection	On/Off
BLC	Area/Value/Off
Anti-flicker	On/Off
Language	English/Chinese
Video	SMART IR, Digital Wide Dynamic Range, Eclipse, Digital Noise Reduction, Sharpness, Brightness, Saturation, Resolution, Electronic image stabilization, Digital Zoom, Mirror, Defect Pixel Correction
Scene	Indoor Standard , Indoor Backlight , Outdoor, Low illumination , IR Standard , Customize
General	
Working Temperature/Humidity	-10 °C - 60 °C (14 °F - 140 °F) Humidity 90% or less (non-condensing)
Power Supply	24 V AC ± 10%, 12 V DC ± 10%
Ingress Protection	IP66
IR Range	approx 20 to 30 meters
Power Consumption	Max. 9.5 W
Dimensions	96.9 x 84.2 x 315.4 mm (3.81" × 3.31" × 12.42")
Weight	2100 g (4.62 lbs)

### Available models

PAL: DS-2CC11A5P- VFIR  
NTSC: DS-2CC11A5N- VFIR