

## DS-2AF1-402 10x Mini Speed Dome

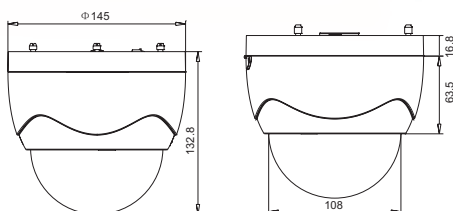

### Specifications

#### Camera

Image Sensor	1/4" Sony EXview HAD CCD
Effective Pixels	PAL: 752 (H)×582 (V) NTSC: 768 (H)×494 (V)
Horizontal Resolution	530TVL
Signal System	NTSC / PAL
Min. Illumination	1.0Lux / F1.4
White Balance	Auto / ATW / Indoor / Outdoor / Manual
AGC	Auto / Manual (On/Off)
S/N Ratio	50dB
BLC	On / Off
Electronic Shutter Speed	NTSC: 1/4s to 1/10,000s PAL: 1/3s to 1/10,000s
Day & Night	Electronic
Digital Zoom	Up to 12x
Private Mask	Up to 24 zones; 8 zones masked simultaneously in one image
Auto Focus	Auto / Manual

#### Pan & Tilt

Pan Range	360° endless rotation
Pan Speed	0.3°/s to 400°/s (proportional zoom ratio)
Tilt Range	0°~90° (auto flip)
Tilt Speed	0.3°/s ~ 150°/s (proportional zoom ratio)
Preset Positions	200
Tour Mode	OFF / Preset / Patrol (up to 8) / Pattern (up to 4) / Auto Scan / Random Scan / Frame Scan / Programmable Preset / Patrol / Auto Scan / Pattern / Random Scan / Frame Scan
Scheduled Task	Freeze frame between presets
Freeze Frame	Previous status
Restore/Reboot	On / Off
PTZ Position Display	

#### Lens

Zoom Ratio	10X Zoom (4.2-42 mm)
Zoom Speed	1.7s (Optical WIDE-TELE)
Field of View	4.6° to 46° (WIDE-TELE)
Min. Working Distance	200 mm to 1000 mm

#### Input/Output

Monitor Output	1.0V[p-p] / 75Ω, NTSC (or PAL) Composite, BNC
----------------	---

#### Alarm

Alarm I/O	2x1
Alarm Trigger	Preset, Patrol, Pattern, Relay Output

#### General

Menu Language	English, Chinese
RS-485 Protocols	HIKVISION, PELCO-P/D (auto format)
Power Supply	24VAC, 40VA / 12VDC, 1.5A
Power Consumption	12W max.
Operating Temperature	-10°C ~ 50°C
Humidity	Up to 90%
Dimensions	4", Φ145 (mm)×132.8 (mm)
Weight (approx.)	2 kg