



**For Security  
Panomorph**

**MP** MEGA PIXELS

**YF360A-SA2**

Applicable camera (model)

1	2/3	1/2	1/3	1/4

**FIXED**

**360°**

**2 Mega**

**DC**

**CS-mt**

**METAL**

**230**

**RoHS**



- 360° view eliminates blind spots
- Optimized design for VGA to 2 Megapixel sensors, both Analog and IP cameras.
- Standard CS Metal Mount for 1/3" sensors.
- Equipped with 3 Axes Sensor Centering Adjustment.
- ImmerVision Enables® SDK available for DVR/ NVR/VMS ([www.immervisionenables.com](http://www.immervisionenables.com)) integration.
- Patented Panomorph Optical Technology.

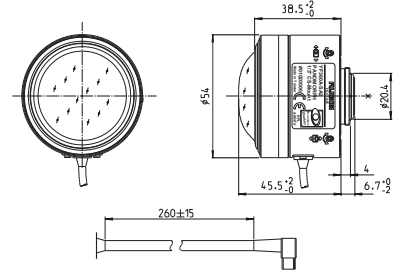

Unit:mm

Focal length (mm)		0.9 (short axis) / 1.15 (long axis)
Iris range		F1.9 (short axis) / F2.4 (long axis)
Operation	Focus	manual
	Iris	Auto (DC Type)*
Angle of view (H x V)		182° x 182°
Anamorphic Ratio		1.3 (4:3)
Focusing Range (from front of the lens) (mm)		∞ ~ 20
Mount		CS
Mass (g)		180
Remarks		Sensor centering adjustment, ImmerVision Enables. (ImmerVision ID: RPL A0NKV) For further information, please visit <a href="http://www.immervision.com">www.immervision.com</a> * When power is turned off, iris will automatically close



[Lens image]



**For Security  
Panomorph**

**MP** MEGA PIXELS

**YF360A-2**

Applicable camera (model)

1	2/3	1/2	1/3	1/4

**FIXED**

**360°**

**2 Mega**

**CS-mt**

**METAL**

**RoHS**



- 360° view eliminates blind spots
- Optimized design for VGA to 2Megapixel sensors, both Analog and IP cameras.
- Standard CS Metal Mount for 1/3" sensors.
- Equipped with 3 Axes Sensor Centering Adjustment.
- ImmerVision Enables® SDK available for DVR/ NVR/VMS ([www.immervisionenables.com](http://www.immervisionenables.com)) integration.
- Patented Panomorph Optical Technology.

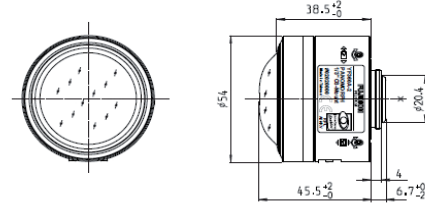

Unit:mm

Focal length (mm)		0.9 (short axis) / 1.15 (long axis)
Iris range		F1.9 (short axis) / F2.4 (long axis)
Operation	Focus	manual
	Iris	none (open iris)
Angle of view (H x V)		182° x 182°
Anamorphic Ratio		1.3 (4:3)
Focusing Range (from front of the lens) (mm)		∞ ~ 20
Mount		CS
Mass (g)		180
Remarks		Sensor centering adjustment, ImmerVision Enables. (ImmerVision ID: RPL A0NKV) For further information, please visit <a href="http://www.immervision.com">www.immervision.com</a>



[Lens image]

