



## VHM/ECLKB-W

Article-No.: 79676

Weatherproof Housing (330mm), w. Heater,  
Thermostat, CBD, RAL9016/7035, 24VAC

### Main features

Camera weather protection  
Fold-down housing body  
Insulated camera mounting  
3 cable entries M16x1.5mm  
Window glass with "Clear-Shield" technology

Housing body length: 330mm  
4 levels of camera height adjustment  
Integrated connection board  
PTC window heater 12-30V included  
Incorporated carrier handle



### Specifications

Series	eneo VHM
Maximum installation length	330
Cable entries	3x M16x1.5mm
Window screen	Coated with "Clear Shield" Technology. With this technology the glass corrosion, caused by environmental pollution, is avoided and screen cleaning cycles will be extended. The coating is UV light resistant, colour neutral and it causes no F-stop loss.
Clear Shield	yes
Window heater	yes
Window heater	12~30V/9watts (PTC)
Thermostat	On: +16°C, Off: +20°C
Blower	no
Wiper	no
Sunshield	yes
Hidden cable management	optional
Integrated wall mount	no
Protection rating	IP66

## Specifications (continued)

Housing	outdoor
Housing material	aluminium
Housing	Aluminium with plastic covers (ABS)
Colour (housing)	RAL9016, RAL7035
Temperature range	-30 to +60°C
Dimensions (HxWxD)	see drawing
Weight	2.8kg
Parts supplied	Screw set, Thermostat switch, Screw terminal
Certificates	CE

## Optional Accessories

Image	Artikel-Nr. / Typ	Description
	WD-16/MK-W	Wall Mount with Swivel Head for VHM Weatherproof Housings, RAL9016
	VHM/PC-1-LG	Plug-in shield for VHM/EC&ST Housing Series, 330mm, RAL7035

## Technical Drawing

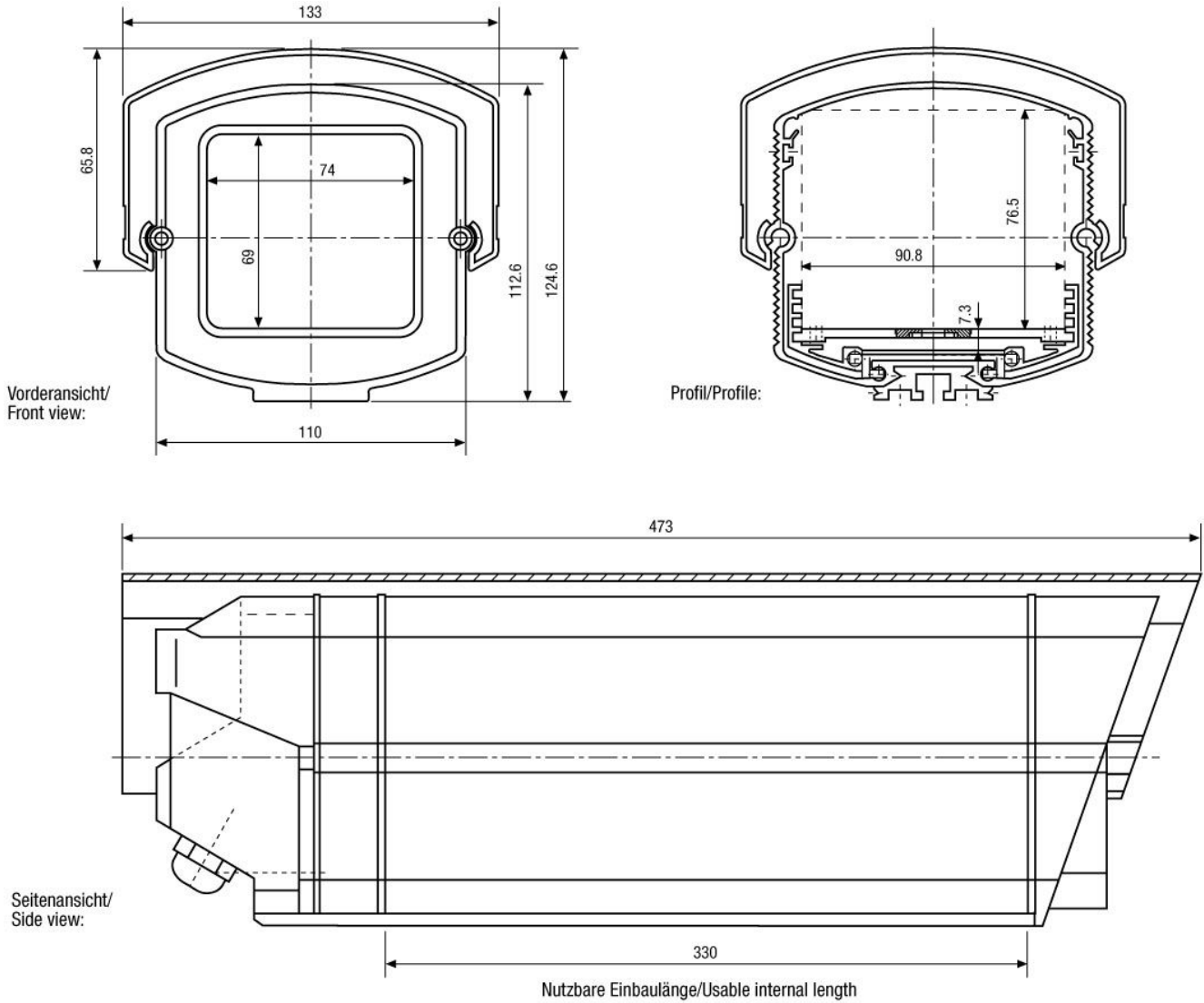

Maße/Dimensions: mm

Your partner for eneo products:

