

# Video Security

Network Cameras | LAN Camera Systems

## ENE0 LAN-03

1/3" NW Colour Camera, F1.4/2.8-11mm  
DC in VHM Weatherproof Housing, 480TVL

Art-No. 96056



## Features

1/3" CCD Colour Camera with MJPEG Compression  
Lens: F1.4/2.8-11mm with DC Controlled Iris  
Transmission Rate: Upto 25 Frames/Sec.  
E-Mail and FTP Transmission of Important Events  
Activity Detection  
Ethernet Interface: 10/100Base-T

Supports Various Network Environments  
Weatherprotected Housing with 24V Screen Heater  
Plugable Connector with 3m Multicore Cable  
Viewing Screen with "Clear-Shield" Technology  
Surface: RAL7032  
Wall Bracket WD-16

## Specifications

<b>Imager</b>	1/3" interlaced CCD
<b>Resolution</b>	480 TV lines (camera) 720x576, 352x288
<b>Sensitivity at 50% video signal</b>	0.76Lux at F1.2 (VT measurement result)
<b>Automatic shutter control (AES)</b>	1/50 - 1/100,000Sec.
<b>Activity detection</b>	Integrated motion detector
<b>Focal length (f)</b>	2.8 ~ 11mm
<b>Horizontal angle of view</b>	97.4° ~ 26.2°
<b>Aperture range</b>	F1.4-F260
<b>Iris control system</b>	Galvanometer
<b>Minimum object distance (M.O.D.)</b>	0.2m
<b>Focus constant range</b>	+0.02mm (Focus deviation at switch-over to IR light at 880nm)
<b>Window screen</b>	Coated with "Clear Shield" Technology. With this technology the glass corrosion, caused by environmental pollution, is avoided and screen cleaning cycles will be extended. The coating is UV light resistant, colour neutral and it causes no F-stop loss.
<b>Window heater</b>	24V, approx. 6watts, with thermostat (On: +16°C, Off: +20°C)

## ENE0 LAN-03

(Specifications continued)

<b>Cable entry</b>	Metal gland M20x1.5mm
<b>Cable connection</b>	3m Multicore cable with open ends
<b>Mounting distance from fixing point</b>	300mm
<b>Turning range of the swivel head</b>	360°
<b>Tilt range</b>	Approx. 50°
<b>Protection rating</b>	IP66
<b>Secondary Storage</b>	Via CF card
<b>Recording</b>	on PC with Viewer Software or on CF Card on camera side
<b>Video output</b>	1 Vp-p, CVBS, 75 ohms, BNC
<b>Compression standard</b>	M-JPEG
<b>Frame rate</b>	25 frames/sec. max.(recording mode), up to 15 frames/sec. (streaming mode)
<b>Transmission rate</b>	up to 15 frames/sec.
<b>Video ring buffer</b>	Stores alarms up-to 3 min.
<b>Image display</b>	Via Web Browser or Lan-Cam-Viewer Software
<b>Alarm input</b>	1 (software controlled)
<b>Alarm outputs</b>	Open collector (5V / 0.02A max.)
<b>Alarm handling</b>	Automatic connection setup to a specified IP address. Sending e-mail with alarm picture (JPEG) automatically
<b>Ethernet interface</b>	10/100 Base-TX, RJ45
<b>Ethernet protocols</b>	TCP, UDP, IP, ARP, ICMP, FTP, DHCP, PPP, HTTP, IGMP
<b>Software upgrade</b>	Via CF card (FAT16 formatted)
<b>Operation protection</b>	Multilevel and Multiuser - Password protected
<b>Serial interfaces</b>	RS-232, RS-485, RJ 45 connector
<b>Supply voltage</b>	230VAC/50Hz
<b>Housing</b>	Aluminium
<b>Colour</b>	RAL7032
<b>Temperature range</b>	-10°C ~ +50°C
<b>Dimensions (HxWxD)</b>	See drawing
<b>Weight</b>	Approx. 3.5kg
<b>Parts supplied</b>	Package consisting of: LAN Camera ENC-1002L with lens, LanCam Viewer Software, Weatherproof housing with power supply unit 230V/50Hz, Screw set, Central plug with built-in 30-pin connector, Wall bracket

## Accessories

<b>71852 / CF CARD/128</b>	CF Memory Card 128MB for ENC-1001L, ENC-1002L, ENC-1003L
<b>71853 / CF CARD/256</b>	CF Memory Card 256MB for ENC-1001L, ENC-1002L, ENC-1003L
<b>70456 / AK-2</b>	Camera Connection Box for Standard and Ethernet Cameras

## Accessories of

<b>71856 / DNR-108/80</b>	Digital IP Recorder (8 Channel), 80Gb 12VDC/230VAC
---------------------------	--

(Accessories of continued)

**71875 / DNR-108/80W**

Digital W LAN IP Recorder (8 Channel), 80Gb,  
12VDC/230VAC

## Product Information

Viewer Software for the recording of upto 4 cameras ENC-1002L

System requirements for the Viewer Software:

- Standard PC with P-IV processor and >1.8GHz system clock
- Windows 2000 or Win XP (in preparation)
- Network connection 10/100 Base-Tx
- Internet Explorer 5 or higher
- Hard disk 80Gb, depend on recording demand
- RAM 512Mb (recommended)

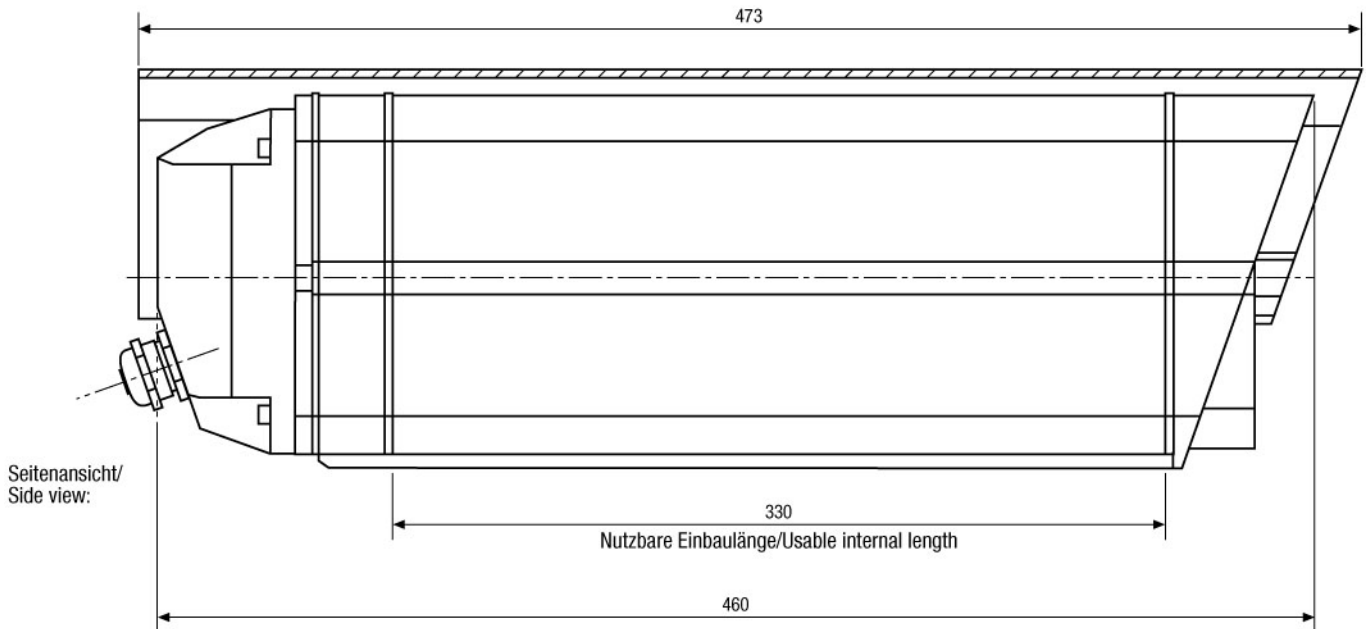
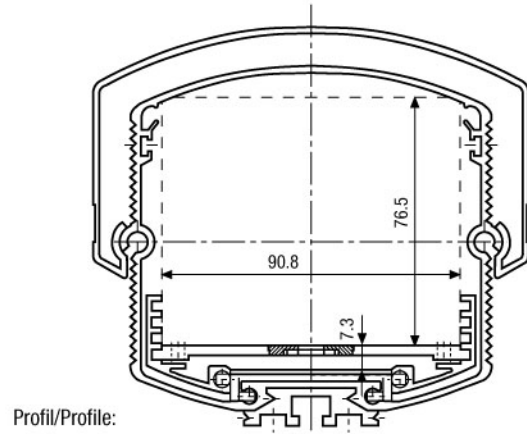
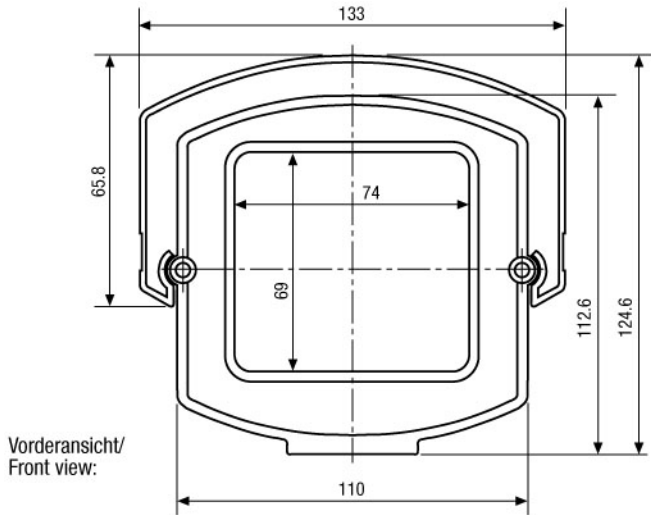

Maße/Dimensions: mm

VIDEOR TECHNICAL E. Hartig GmbH  
 Carl-Zeiss-Straße 8 · 63322 Rödermark · Germany  
 Telefon +49 (0) 60 74/8 88-0 · Telefax +49 (0) 60 74/8 88-100  
 info@videortechnical.com · www.videortechnical.com

