

Video Security



G20Z05NDDC

F1.6/20-100mm DC Lens, 1/2" CS,
Variable Focal Length

Art-No. 43247



Features

Suitable for 1/2" and 1/3" Colour and B&W Cameras
5x Variable Focal Length
Aspherical Lens Elements
Compact Design
Locking Mechanism for Focus and Zoom

CS Mount
High Standard of Optical and Mechanical Quality
DC Auto Iris
4-pin Connector for DC Iris Control
Adjustable Slip-ring Mount for Cable Positioning

Specifications

Nominal format size	1/2"
Focal length (f)	20 ~ 100mm
Aperture range (F)	F1.6 ~ F270
Iris control system	Galvanometer
Horizontal angle of view at nominal format size	Approx. 18° ~ 3.6°
Minimum object distance (M.O.D.)	1.0m
Flange focal length	12.5mm
Screw-in depth	4.0mm
Filter screw size	-
Slip-ring mount	340° ~ 360° Variable adjustment range
Cable length	Approx. 20cm
4-pin plug	Standard
Lens mount	CS
Temperature range	-20°C ~ +60°C
Dimensions (LxDxH)	See drawing
Weight	Approx. 160g

Accessories of

91091 / TK-C1480BE

1/2" Colour Camera 12VDC/24VAC, 480TVL

91092 / TK-C1481BEG

1/2" Colour Camera 230VAC, 480TVL

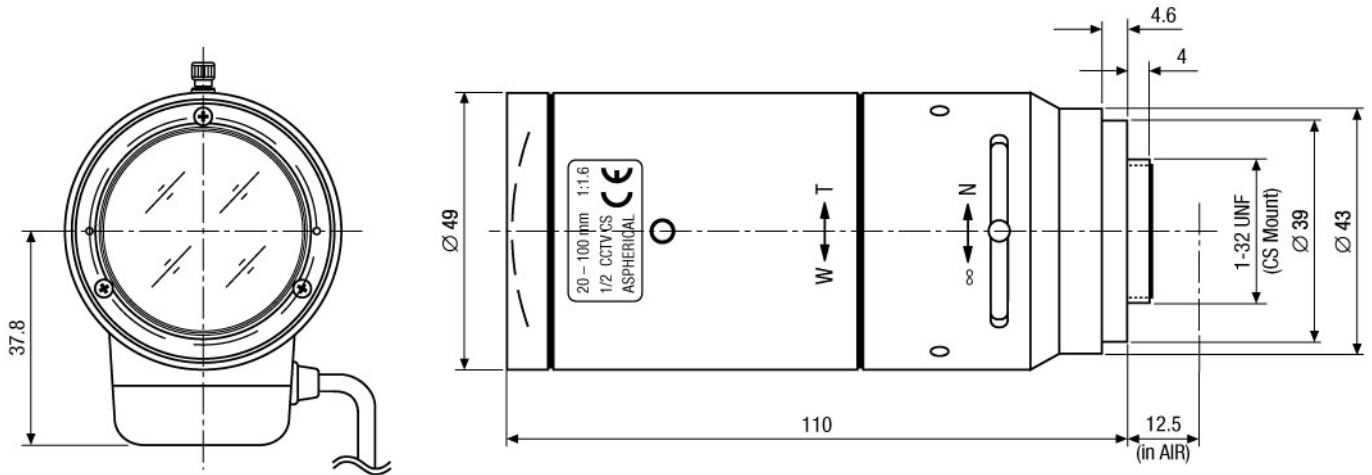

Maße/Dimensions: mm

VIDEOR TECHNICAL E. Hartig GmbH
 Carl-Zeiss-Straße 8 · 63322 Rödermark · Germany
 Telefon +49 (0) 60 74/8 88-0 · Telefax +49 (0) 60 74/8 88-100
 info@videortechnical.com · www.videortechnical.com