



BOSCH
Invented for life

LTC 1361, 146x Series FlexiDomeXT Vandal Resistant Cameras



- ▶ Vandal resistant camera in weatherproof housing
- ▶ Endures the equivalent of 50 kg (120 lbs) of force
- ▶ High resolution monochrome and 540 TVL color models
- ▶ Extended sensitivity with NightSense
- ▶ Auto-iris varifocal lenses
- ▶ Line-Lock with phase adjustment
- ▶ Flush mount appearance
- ▶ Conduit compatible hard surface mount option

The FlexiDome^{XT} line of vandal resistant, fixed Dome cameras with varifocal lens options provide the ultimate solution for virtually any indoor and outdoor security application. Providing a full-featured integrated camera in a cast aluminum housing, polycarbonate dome, and hardened inner liner these units can withstand the equivalent of 50 kg (120 lbs) of force. FlexiDome^{XT} cameras are also sealed for outdoor use with protection against water and dust to IP66, (NEMA-4) standards.

Functions

The FlexiDome^{XT} Series incorporates the latest technology found in an integrated camera with the option of 540 TVL resolution color and monochrome cameras that feature an integrated varifocal DC iris lens. The choice of varifocal lenses makes the application of these cameras extremely versatile, covering standard and telephoto as well as low light applications. AC and DC compatible, users get an added benefit of Line-Locking and phase adjustment capabilities when AC voltage is employed. Backlight compensation can also be selected on all models. NightSense is used to further extend the excellent sensitivity by a factor of 3 in monochrome operation. This mode is automatically activated in color cameras under low light conditions.

For quick and easy installation, the FlexiDome^{XT} Series cameras come completely assembled, and ready to use. Using the proprietary pan/tilt/rotation mechanism, camera adjustments are simple. Cameras can be rotated 360° and tilted more than 90° to choose precisely the camera angle you need for installation.

Each unit is supplied with an adaptor plate compatible with single, double, or 4S electrical box installations. For solid wall or ceiling mounting, the optional LTC 1347 Hard Surface Mount Adaptor box is offered. This adaptor can be wired through the side of the housing via a standard 3/4in. conduit opening, or wired through the back of the unit. For hassle-free on-site setup and adjustments, an optional Video Service cable (S1460) is available.

FlexiDome^{XT} is an ideal, no compromise solution for numerous surveillance applications, especially over conventional camera limitations. The small, sleek design and virtually flush mount appearance allow for an attractive look that compliments various decors, and at the same time providing the extra protection necessary for applications such as schools, banks, hotels, prisons, parking garages, retail, and commercial installations.

Installation/Configuration Notes

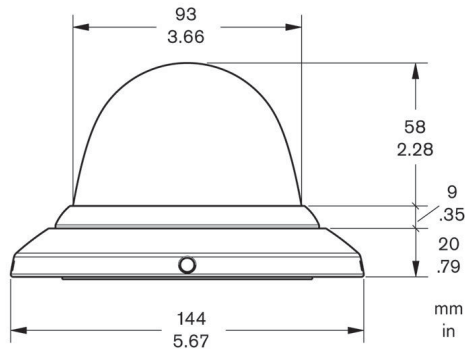

Dimensions

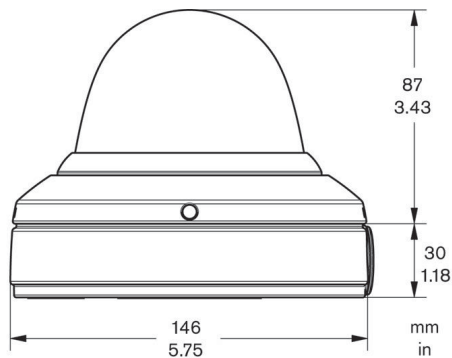

with LTC 1347 connection box

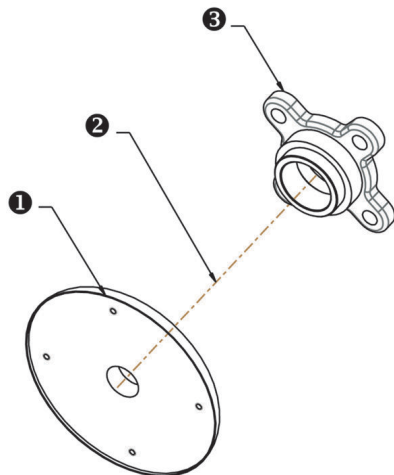

Pipe Mount Dimensions LTC 1349/00

- 1 Pendant Cap
- 2 3/4-inch pipe with 3/4-inch -14 NPSM threads or EMT conduits both ends (not included)
- 3 Flange Assembly

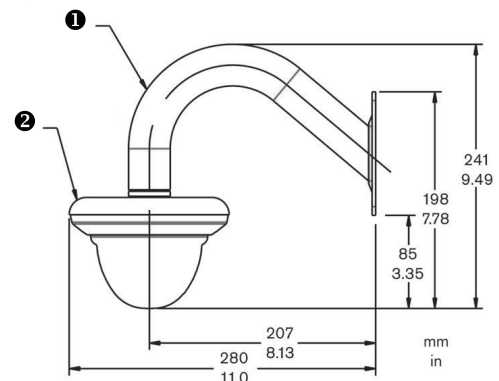
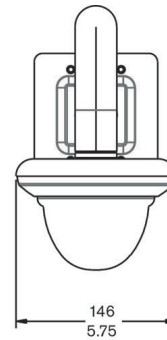

Pendant Mount Dimensions LTC 1348/00

- 1 Wall Mount Assembly
- 2 Pendant Cap

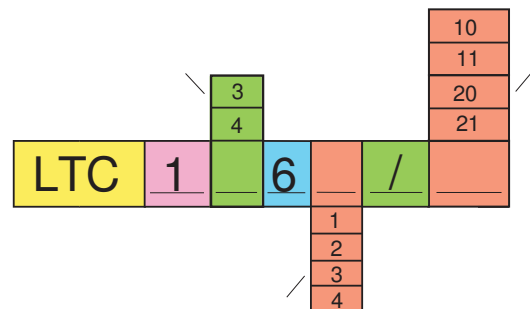

- 1 3 - B/W
4 - Color
- 2 1 - 2.8-6 mm F1.4 Varifocal
2 - 2-4 mm F1.4 Varifocal
3 - 3-6 mm F 1.2 Varifocal
4 - 4-9 mm F1.4 Varifocal
- 3 10 - CCIR
20 - EIA
11 - PAL
21 - NTSC

Parts Included

Quantity Component

1	LTC 1361 or 146x Series FlexiDome ^{XT} Vandal Resistant Camera
---	---

Technical Specifications

Electrical

Model No.	Lens	System
LTC 1361/10	2.8 – 6mm, F1.4	B&W, CCIR, 50Hz
LTC 1361/20	2.8 – 6mm, F1.4	B&W, EIA, 60Hz
LTC 1461/11	2.8 – 6mm, F1.4	Color, PAL, 50Hz
LTC 1461/21	2.8 – 6mm, F1.4	Color, NTSC, 60Hz
LTC 1462/11	2 – 4mm, F1.4	Color, PAL, 50 Hz
LTC 1462/21	2 – 4mm, F1.4	Color NTSC, 60 Hz
LTC 1463/11	3 – 6mm, F1.2	Color, PAL, 50Hz
LTC 1463/21	3 – 6mm, F1.2	Color, NTSC, 60Hz
LTC 1464/11	4 – 9mm, F1.4	Color, PAL, 50Hz
LTC 1464/21	4 – 9mm, F1.4	Color, NTSC, 60Hz

Voltage Range

/11 & /10 versions	12 to 24VAC, 50Hz or 12 to 33VDC, 2 W	
/21 & /20 versions	12 to 24VAC, 60Hz or 12 to 33VDC, 2 W	
Lens	DC-iris Integrated Varifocal	
2 – 4 mm	Viewing angle	105° - 53°
2.8 – 6 mm	Viewing angle	76° - 35°
3 – 6 mm	Viewing angle	72° - 35°
4 – 9 mm	Viewing angle	52° - 24°
Imager	Interline transfer CCD, 1/4-inch. Image format	

Horizontal Resolution

LTC 136x B&W Series	570 TVL
LTC 146x Color Series	540 TVL
Electronic Shutter	1/50 (1/60) to 1/100,000 sec

Sensitivity

		Usable picture		Full Video
		30 IRE	50 IRE	
LTC 1361	fc	0.01	0.02	0.08
	lux	0.1	0.2	0.8

LTC 1461, 1462 & 1464

Color	fc	0.1	0.2	0.8
	lux	1	2	8
NightSense	fc	0.03	0.07	0.27
	lux	0.3	0.7	2.7

LTC 1463

Color	fc	0.07	0.15	0.6
	lux	0.7	1.5	6
NightSense	fc	0.02	0.05	0.2
	lux	0.2	0.5	2

At 89% scene reflection and 3200K illumination

Signal-to-Noise Ratio 48dB

Automatic Gain Control 18dB

White Balance (Color Models Only)

Automatic Sensing through the Lens: 2500K to 9000K Continuous (ATW) or Hold (AWB)

Aperture Correction Horizontal and vertical

Synchronization

Line-Lock (When powered by AC)	Synchronizes camera to power line zero crossings for roll-free interval switching. Vertical phase delay can be continuously adjusted to allow vertical synchronization in multiphase power installations
Crystal-Lock	selected when DC supplied or Line-Lock OFF

Controls

Automatic White Balance	On (ATW) / Off (AWB)
Backlight Compensation	On / Off
NightSense	On / Off
Line-Lock	On / Off, with phase adjustment of

Connectors

Video Out	BNC on coax cable
Power	Stripped leads
Internal Video Monitor Connector	2.5 mm mono jack S1460 required

Mechanical

Cable Entry Through back, optional connection box available for side entry (1/2 - inch conduit or 22 mm gland, PG16)

Mounting	On wall or ceiling using up to 4 screws
Construction	Polycarbonate clear dome on aluminum housing
Color	White trim ring with black inner liner, /10 includes gray trim ring
Dimensions	See drawing
Weight	500g (1.1lb)

Environmental

Operating Temp.	-30°C to +50°C (-22°F to +122°F)
Storage Temp.	-40°C to +70°C (-40°F to +158°F)
Humidity	0% to 90% relative humidity, non condensing
Water & Dust Protection	IP66 (NEMA 4), when mounted on a flat surface
Impact Protection	IEC 60068-2-75 test Eh ≥50 Joules EN 50102, exceeding IK10

Product Regulatory Compliance

Electromagnetic Compatibility (EMC)	CE Immunity, FCC Class B
Safety	UL, cUL, CE

Ordering Information

LTC 1361/10 FlexiDome XT vandal resistant, 1/4-inch B/W CCIR, 570 TVL, 12 VDC/24 VAC, 50 Hz, w/2.8-6 mm F1.4 var- ifocal lens, white/grey	LTC1361/10
LTC 1361/20 FlexiDome XT vandal resistant, 1/4-inch B/W EIA, 570 TVL, 12 VDC / 24 VAC, 60 Hz, w/2.8 – 6 mm F1.4 varifocal lens, white	LTC 1361/20
LTC 1461/11 FlexiDome XT vandal resistant, 1/4-inch color PAL, 540 TVL, 12 VDC/24 VAC, 50 Hz, w/2.8 – 6 mm F1.4 varifocal lens, white/grey	LTC1461/11
LTC 1461/21 FlexiDome XT vandal resistant, 1/4-inch color NTSC, 540 TVL, 12 VDC/24 VAC, 60 Hz, w/ 2.8 – 6 mm F1.4 varifocal lens, white	LTC 1461/21
LTC 1462/11 FlexiDome XT vandal resistant, 1/4-inch color PAL, 540 TVL, 12 VDC/24 VAC, 50 Hz, w/2 – 4 mm F1.4 var- ifocal lens, white/grey	LTC1462/11
LTC 1462/21 FlexiDome XT vandal resistant, 1/4-inch color NTSC, 540 TVL, 12 VDC/24 VAC, 60 Hz, w/2 – 4 mm F1.4 varifocal lens, white	LTC 1462/21
LTC 1463/11 FlexiDome XT vandal resistant, 1/4-inch color PAL, 540 TVL, 12 VDC/24 VAC, 50 Hz, w/3 – 6 mm F1.2 var- ifocal lens, white/grey	LTC1463/11
LTC 1463/21 FlexiDome XT vandal resistant, 1/4-inch color NTSC, 540 TV, 12 VDC/24 VAC, 60 Hz, w/3 – 6 mm F1.2 var- ifocal lens, white	LTC 1463/21

Ordering Information

LTC 1464/11 FlexiDome XT vandal resistant, 1/4-inch color PAL, 540 TVL, 12 VDC/24 VAC, 50 Hz, w/4 – 9 mm F1.4 var- ifocal lens, white/grey	LTC1464/11
LTC 1464/21 FlexiDome XT vandal resistant, 1/4-inch color NTSC, 540 TVL, 12 VDC/24 VAC, 60 Hz, w/ 4 – 9 mm F1.4 varifocal lens, white	LTC 1464/21
Accessories	
TC 220PSX-24 Power Supply Unit 230 VAC/20 VAC, 50 Hz, 20 VA	TC220PSX-24
LTC 1347/00 Surface Mount Box for FlexiDome XT, side entry conduit, white	LTC1347/00
LTC 1347/01 Surface Mount Box for FlexiDome XT, side entry conduit, grey	LTC1347/01
LTC 1348/00 Pendant Wall Mount Kit for FlexiDome XT, white	LTC1348/00
LTC 1349/00 Pendant Pipe Mount Kit for FlexiDome XT, white	LTC1349/00

Americas:
Bosch Security Systems, Inc.
130 Perinton Parkway
Fairport, New York, 14450, USA
Phone: +1 800 289 0096
Fax: +1 585 223 9180
security.sales@us.bosch.com
www.boschsecurity.us

Europe, Middle East, Africa:
Bosch Security Systems B.V.
P.O. Box 80002
5600 JB Eindhoven, The Netherlands
Phone: +31 40 2577 284
Fax: +31 40 2577 330
emea.securitysystems@bosch.com
www.boschsecurity.com

Asia-Pacific:
Bosch Security Systems Pte Ltd
38C Jalan Pemimpin
Singapore 577180
Phone: +65 6319 3450
Fax: +65 6319 3499
apr.securitysystems@bosch.com
www.boschsecurity.com

Represented by